

Cable Sealing Backshell

RS Series • MIL-DTL-5015 Series Reverse Bayonet



RS06WN12-3PN - E2

- 1 **CONNECTOR PART NUMBER**
Basic RS Series part number
- 2 **BACKSHELL PART NUMBER (ADD TO CONNECTOR)**
E2 Environmental cable sealing backshell w/
compression gland & strain relief cable clamp

Note: See part builder (p. V-11) for additional kit options.

RSE2 Compatibility

Compatible Brands	Compatible Connectors
AS95234	AS95234/1, AS95234/4, AS95234/5, AS95234/6, AS95234/7, AS95234/8, AS95234/9
VG95234	VG95234 Plugs, VG95234 Receptacles
Amphenol	GTS00, GTS01, GTS030, GTS06, GTS070, GTC00, GTC01, GTC030, GTC06, GTC070 ACA3100-B, ACA3101-B, ACA3103-B, ACA3106-B 97B-3100, 97B-3101, 97B-3106, 97B-3107, 97B-4100, 97B-4101, 97B-4106, 97B-4107
ITT Cannon	CA3100, CA3101, CA3106, CB0, CB1, CB6
Veam	CIR00, CIR030, CIR06, CIR070

Backshell Dimensions

Shell Size	Approximate Max Length With Matching Connectors					B	L	CC Cable Entry Max
	RS06	RS00	RS04	RS07	RS01			
10SL	2.598 (66.0)	2.598 (66.0)	2.717 (69.0)	3.051 (77.5)	2.598 (66.0)	.937 (23.8)	2.318 (58.9)	.312 (7.9)
14S	2.795 (71.0)	2.795 (71.0)	2.913 (74.0)	3.346 (85.0)	2.795 (71.0)	1.062 (27.0)	2.318 (58.9)	.438 (11.1)
16S	2.795 (71.0)	2.795 (71.0)	2.913 (74.0)	3.358 (85.3)	2.795 (71.0)	1.188 (30.2)	2.318 (58.9)	.562 (14.3)
16	3.071 (78.0)	3.071 (78.0)	3.150 (80.0)	4.012 (101.9)	3.071 (78.0)	1.188 (30.2)	2.318 (58.9)	.562 (14.3)
18	3.228 (82.0)	3.228 (82.0)	3.189 (81.0)	3.701 (94.0)	3.228 (82.0)	1.312 (33.3)	2.458 (62.4)	.625 (15.9)
20	3.228 (82.0)	3.228 (82.0)	3.189 (81.0)	3.705 (94.1)	3.228 (82.0)	1.562 (39.2)	2.458 (62.4)	.750 (19.1)
22	3.268 (83.0)	3.268 (83.0)	3.228 (82.0)	3.819 (97.0)	3.268 (83.0)	1.562 (39.2)	2.458 (62.4)	.750 (19.1)
24	3.386 (86.0)	3.386 (86.0)	3.307 (84.0)	3.917 (99.5)	3.386 (86.0)	1.750 (44.5)	2.583 (65.6)	.938 (23.8)
28	3.622 (92.0)	3.622 (92.0)	3.622 (92.0)	4.256 (108.1)	3.622 (92.0)	1.750(44.5)	2.587 (65.7)	.938 (23.8)
32	4.016 (102.0)	4.016 (102.0)	4.015 (102.0)	4.587 (116.5)	4.016 (102.0)	2.250 (57.2)	2.794 (71.0)	1.250 (31.8)
36	4.213 (107.0)	4.213 (107.0)	4.213 (107.0)	4.783 (121.5)	4.213 (107.0)	2.375 (60.3)	3.044 (77.3)	1.375 (34.9)

Dimensions are in inches (mm).

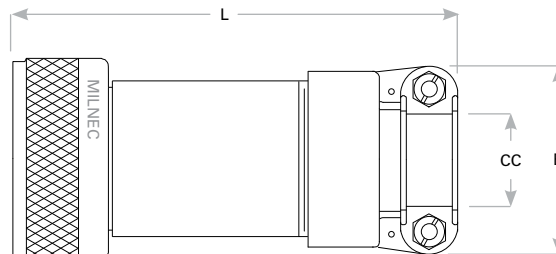

Rev. 1832