

Cable Bushing

RS Series • MIL-DTL-5015 Series Reverse Bayonet

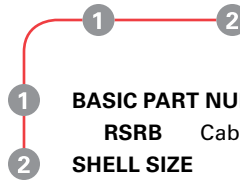

RSRB - 16



1 BASIC PART NUMBER

RSRB Cable bushing

2 SHELL SIZE

See Bushing Shell Size Selector table below

Note: Individual bushings can be ordered for wire bundles too small to seal properly within a single sleeve. Additional bushings should be ordered one size smaller or bigger to nest inside one another.

RSRB Compatibility

Compatible Brands	Connectors
AS95234	AS95234/1, AS95234/4, AS95234/5, AS95234/6, AS95234/8, AS95234/9
VG95234	VG95234 Plugs, VG95234 Receptacles
Amphenol	GTS00, GTS01, GTS030, GTS06, GTS070 GTC00, GTC01, GTC030, GTC06, GTC070 ACA3100-B, ACA3101-B, ACA3103-B, ACA3106-B 97B-3100, 97B-3101, 97B-3106, 97B-3107 97B-4100, 97B-4101, 97B-4106, 97B-4107
ITT Cannon	CA3100, CA3101, CA3106 CB0, CB1, CB2, CB6
Veam	CIR00, CIR030, CIR06, CIR070

Bushing Shell Size Selector

Shell Size	Bushing Included
10	RSRB34-4
12	RSRB34-4
14	RSRB34-6
16	RSRB34-8
18	RSRB34-10
20	RSRB34-12
22	RSRB34-12
24	RSRB34-12, RSRB34-16
28	RSRB34-12, RSRB34-16
32	RSRB34-16, RSRB34-20
36	RSRB34-20, RSRB34-24

Two bushings, designed to nest inside one another, are supplied with shell sizes 24 and larger.

Bushing Dimensions

Bushing Part Numbers	M	L ²	D	G
RSRB34-3	.130 (3.3)	2.875 (73.0)	.374 (9.5)	.210 (5.3)
RSRB34-4	.220 (5.6)	2.750 (69.9)	.500 (12.7)	.302 (7.7)
RSRB34-6	.312 (7.9)	2.625 (66.7)	.614 (15.6)	.427 (10.9)
RSRB34-8	.437 (11.1)	2.500 (63.5)	.739 (18.8)	.552 (14.0)
RSRB34-10	.562 (14.3)	2.375 (60.3)	.889 (22.6)	.615 (15.6)
RSRB34-12	.625 (15.9)	2.250 (57.2)	1.084 (27.5)	.740 (18.8)
RSRB34-16	.750 (19.1)	2.125 (54.0)	1.309 (33.3)	.927 (23.6)
RSRB34-20	.937 (23.8)	2.000 (50.8)	1.592 (40.4)	1.240 (31.5)
RSRB34-24	1.250 (31.8)	1.875 (47.6)	1.842 (46.8)	1.365 (34.7)

Dimensions are in inches (mm).

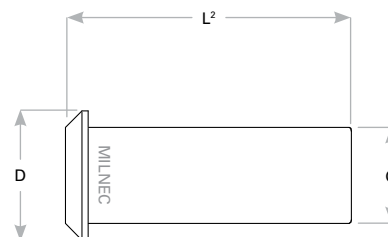
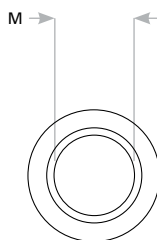

Rev. 1832