

# Wire Sealing Backshell

RS Series • MIL-DTL-5015 Series Reverse Bayonet



## RS06WN12-3PN - F2

- 1 **CONNECTOR PART NUMBER**  
Basic RS Series part number
- 2 **BACKSHELL PART NUMBER (ADD TO CONNECTOR)**  
**F2** Environmental wire sealing backshell w/  
wire grommet & strain relief cable clamp

**Note:** See part builder (p. V-11) for additional kit options.

### RSF2 Equivalents

| Compatible Brands | Compatible Connectors  |
|-------------------|--|
| <b>AS95234</b>    | AS95234/1, AS95234/4, AS95234/5, AS95234/6, AS95234/7, AS95234/8, AS95234/9  |
| <b>VG95234</b>    | VG95234 Plugs, VG95234 Receptacles   |
| <b>Amphenol</b>   | GTS00, GTS01, GTS030, GTS06, GTS070, GTC00, GTC01, GTC030, GTC06, GTC070<br>ACA3100-B, ACA3101-B, ACA3103-B, ACA3106-B<br>97B-3100, 97B-3101, 97B-3106, 97B-3107, 97B-4100, 97B-4101, 97B-4106, 97B-4107 |
| <b>ITT Cannon</b> | CA3100, CA3101, CA3106, CB0, CB1, CB6  |
| <b>Veam</b>       | CIR00, CIR030, CIR06, CIR070   |

### Backshell Dimensions

| Shell Size  | Approximate Overall Length With Matching Connectors |              |              |              |              | B            | L            | CC Cable Entry Max |
|-------------|---|--------------|--------------|--------------|--------------|--------------|--------------|--------------------|
|             | RS06  | RS00         | RS04         | RS07         | RS01         |              |              |                    |
| <b>10SL</b> | 2.244 (57.0)  | 2.323 (59.0) | 2.402 (61.0) | 2.728 (69.3) | 2.323 (59.0) | .894 (22.7)  | 1.579 (40.1) | .312 (7.9)         |
| <b>14S</b>  | 2.402 (61.0)  | 2.480 (63.0) | 2.598 (66.0) | 2.898 (73.6) | 2.480 (63.0) | 1.083 (27.5) | 1.642 (41.7) | .438 (11.1)        |
| <b>16S</b>  | 2.560 (64.0)  | 2.560 (65.0) | 2.677 (68.0) | 2.969 (75.4) | 2.560 (65.0) | 1.181 (30.0) | 1.713 (43.5) | .562 (14.3)        |
| <b>16</b>   | 2.835 (72.0)  | 2.795 (71.0) | 2.874 (73.0) | 3.346 (85.0) | 2.795 (71.0) | 1.181 (30.0) | 1.713 (43.5) | .562 (14.3)        |
| <b>18</b>   | 2.913 (74.0)  | 2.795 (71.0) | 2.874 (73.0) | 3.634 (92.3) | 2.795 (71.0) | 1.299 (33.0) | 1.969 (50.0) | .625 (15.9)        |
| <b>20</b>   | 2.913 (74.0)  | 2.795 (71.0) | 2.874 (73.0) | 3.457 (87.8) | 2.795 (71.0) | 1.476 (37.5) | 1.791 (45.5) | .750 (19.1)        |
| <b>22</b>   | 2.992 (76.0)  | 2.874 (73.0) | 2.874 (73.0) | 3.457 (87.8) | 2.874 (73.0) | 1.476 (37.5) | 1.791 (45.5) | .750 (19.1)        |
| <b>24</b>   | 3.071 (78.0)  | 2.992 (76.0) | 2.913 (74.0) | 3.535 (89.8) | 2.992 (76.0) | 1.705 (43.3) | 1.870 (47.5) | .938 (23.8)        |
| <b>28</b>   | 3.268 (83.0)  | 3.268 (83.0) | 3.268 (83.0) | 3.642 (92.5) | 3.268 (83.0) | 1.705 (43.3) | 1.874 (47.6) | .938 (23.8)        |
| <b>32</b>   | 3.465 (88.0)  | 3.465 (88.0) | 3.504 (89.0) | 3.598 (91.4) | 3.465 (88.0) | 2.035 (51.7) | 1.831 (46.5) | 1.250 (31.8)       |
| <b>36</b>   | 3.504 (89.0)  | 3.543 (90.0) | 3.543 (90.0) | 3.594 (91.3) | 3.543 (90.0) | 2.283 (58.0) | 1.827 (46.4) | 1.375 (34.9)       |

Dimensions are in inches (mm).

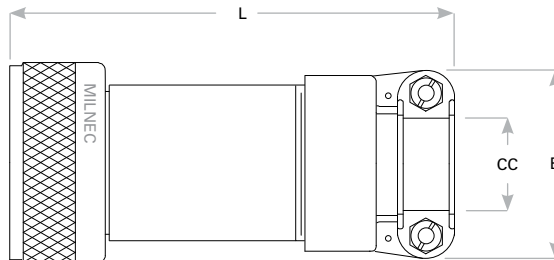

Rev. 1832