

Cable Bushing

PS Series • High-Performance Solder Connectors



PSRB - 16

- 1 **BASIC PART NUMBER**
PSRB Cable bushing
- 2 **SHELL SIZE**
See Bushing Shell Size Selector table below

Note: Individual bushings can be ordered for wire bundles too small to seal properly within a single sleeve. Additional bushings should be ordered one size smaller or bigger to nest inside one another.

 **Protects wires & provides additional sealing**
These neoprene bushings provide an additional environmental seal, and they protect the wire jackets from friction against the strain relief clamps.

Bushing Shell Size Selector

Shell Size	Bushing Included
10	PSRB34-4
12	PSRB34-4
14	PSRB34-6
16	PSRB34-8
18	PSRB34-10
20	PSRB34-12
22	PSRB34-12
24	PSRB34-12, PSRB34-16
28	PSRB34-12, PSRB34-16
32	PSRB34-16, PSRB34-20
36	PSRB34-20, PSRB34-24

Two bushings, designed to nest inside one another, are supplied with shell sizes 24 and larger.

Bushing Dimensions

Bushing Part Numbers	M	L ²	D	G
PSRB34-3	.130 (3.3)	2.875 (73.0)	.374 (9.5)	.210 (5.3)
PSRB34-4	.220 (5.6)	2.750 (69.9)	.500 (12.7)	.302 (7.7)
PSRB34-6	.312 (7.9)	2.625 (66.7)	.614 (15.6)	.427 (10.9)
PSRB34-8	.437 (11.1)	2.500 (63.5)	.739 (18.8)	.552 (14.0)
PSRB34-10	.562 (14.3)	2.375 (60.3)	.889 (22.6)	.615 (15.6)
PSRB34-12	.625 (15.9)	2.250 (57.2)	1.084 (27.5)	.740 (18.8)
PSRB34-16	.750 (19.1)	2.125 (54.0)	1.309 (33.3)	.927 (23.6)
PSRB34-20	.937 (23.8)	2.000 (50.8)	1.592 (40.4)	1.240 (31.5)
PSRB34-24	1.250 (31.8)	1.875 (47.6)	1.842 (46.8)	1.365 (34.7)

Dimensions are in inches (mm).

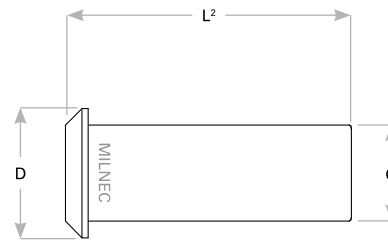
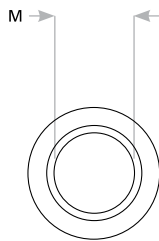

Rev. 1112.1