

M28840/3 Type 45° Strain Relief Backshell

Ry85049 Series • M85049 Type Backshells

RY28840/3 C W

- 1 **BASIC PART NUMBER**
RY28840/3
M28840/3 type
45° strain relief backshell
- 2 **DESIGNATOR**
See Dimensions table below
- 3 **MATERIAL & FINISH**
W Aluminum, olive drab cadmium
D Corrosion resistant steel, black cadmium plate



Photo for example only

RY28840/3 Compatibility

Compatible Connector Series

MIL-DTL-28840

Backshell Dimensions

Designator	Shell Size	V Thread Class 2B	L Max	D Max	F Max	B Max	CC Cable Clearance	
							Min	Max
A	11	0.750 - 20 UNEF	1.650 (41.9)	1.028 (26.1)	0.929 (23.6)	0.903 (22.9)	0.177 (4.5)	0.286 (7.3)
B	13	0.875 - 20 UNEF	1.650 (41.9)	1.141 (29.0)	0.929 (23.6)	0.977 (24.8)	0.177 (4.5)	0.286 (7.3)
C	15	1.000 - 20 UNEF	1.765 (44.8)	1.263 (32.1)	1.056 (26.8)	1.151 (29.2)	0.250 (6.4)	0.416 (10.6)
D	17	1.125 - 18 UNEF	1.874 (47.6)	1.387 (35.2)	1.233 (31.3)	1.281 (32.5)	0.291 (7.4)	0.476 (12.1)
E	19	1.250 - 18 UNEF	1.918 (48.7)	1.513 (38.4)	1.296 (32.9)	1.406 (35.7)	0.348 (8.8)	0.626 (15.9)
F	23	1.438 - 18 UNEF	1.962 (49.8)	1.703 (43.3)	1.358 (34.5)	1.576 (40.0)	0.429 (10.9)	0.831 (21.1)
G	25	1.562 - 18 UNEF	2.006 (51.0)	1.825 (46.4)	1.420 (36.1)	1.666 (42.3)	0.523 (13.3)	0.956 (24.3)
H	29	1.875 - 16 UN	2.301 (58.4)	2.143 (54.4)	1.634 (41.5)	2.046 (52.0)	0.643 (16.3)	1.081 (27.5)
J	33	2.062 - 16 UNS	2.389 (60.7)	2.329 (59.2)	1.859 (47.2)	2.209 (56.1)	0.704 (17.9)	1.187 (30.1)

Dimensions are in inches (mm).

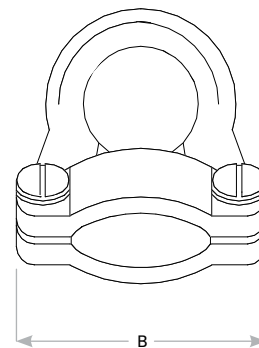
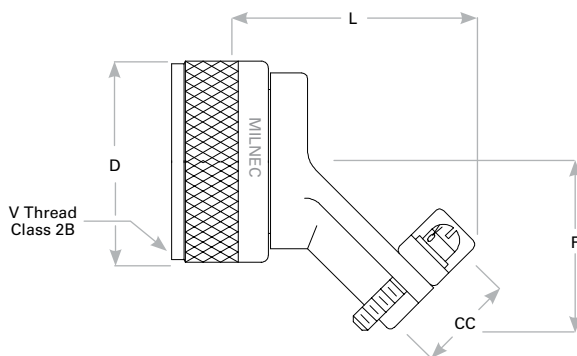

Rev. 1825