

# M85049/130 Type Gasket

RY85049 Series • M85049 Type Backshells

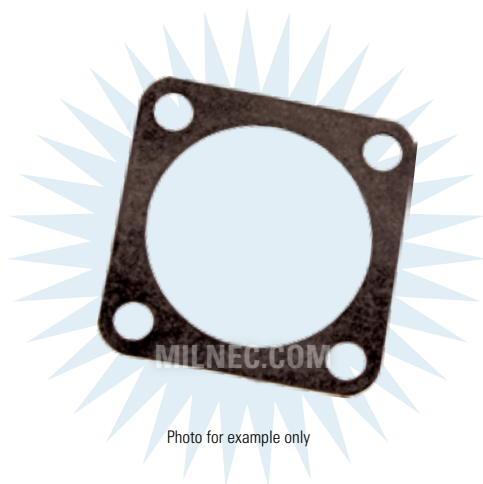

## RY85049/130 - 16 N

- 1 **BASIC PART NUMBER**  
**RY85049/130**  
M85049/130 type  
Gasket
- 2 **DASH NO.**  
See dimensions table below
- 3 **MATERIAL**
  - C** Conductive silicone, aluminum or monel mesh  
Capable of 80 dB at 100 MHz  
Temperature range -71° to 500° F (-57° to +260° C)
  - F** Fluorosilicone (IAW SAE AMS-R-25988)
  - M** Conductive silver filled silicone  
(IAW MIL-DTL-3528 Type B)  
Capable of 110 dB at 10GHz  
Temperature Range -67° to 500° F (-55° to +260° C)
  - N** Neoprene (IAW AMS 3208)
  - S** Silicone (IAW AA-59588)
  - V** Viton (IAW MIL-R-83248)

### RY85049/130 Compatibility

#### Compatible Connector Series

Consult your distributor

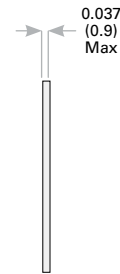
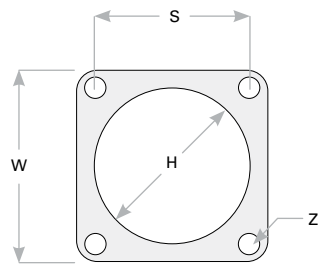

### RY85049/130 Dimensions

Dash No.	W Max	S	H	Z
01	0.812 (20.6)	0.594 (15.1)	0.568 (14.4)	0.125 (3.2)
02	0.875 (22.2)	0.594 (15.1)	0.500 (12.7)	0.156 (4.0)
03	0.896 (22.8)	0.625 (15.9)	0.603 (15.3)	0.125 (3.2)
04	0.937 (23.8)	0.719 (18.3)	0.680 (12.3)	0.125 (3.2)
05	1.000 (25.4)	0.719 (18.3)	0.625 (15.9)	0.156 (4.0)
06	1.023 (26.0)	0.750 (19.1)	0.750 (19.1)	0.125 (3.2)
07	1.060 (26.9)	0.812 (20.6)	0.875 (22.2)	0.141 (3.6)
08	1.114 (28.3)	0.812 (20.6)	0.828 (21.0)	0.125 (3.2)
09	1.094 (27.8)	0.813 (20.7)	0.750 (19.1)	0.141 (3.6)
10	1.138 (28.9)	0.843 (21.4)	0.875 (22.2)	0.125 (3.2)

Dimensions are in inches (mm).

(Continued on next page)

Rev. 1825

# M85049/130 Type Gasket

Ry85049 Series • M85049 Type Backshells

## Ry85049/130 Dimensions (Continued from previous page)

Shell Size	W Max	S	H	Z
11	1.153 (29.3)	0.906 (23.0)	1.005 (25.5)	0.125 (3.2)
12	1.125 (28.6)	0.906 (23.0)	0.938 (23.8)	0.125 (3.2)
13	1.188 (30.2)	0.906 (23.0)	0.875 (22.2)	0.156 (4.0)
14	1.258 (32.0)	0.969 (24.6)	1.135 (28.8)	0.156 (4.0)
15	1.250 (31.8)	0.969 (24.6)	1.063 (27.0)	0.125 (3.2)
16	1.281 (32.5)	0.969 (24.6)	1.000 (25.4)	0.156 (4.0)
17	1.383 (35.1)	1.015 (25.8)	1.125 (28.6)	0.125 (3.2)
18	1.351 (34.3)	1.062 (27.0)	1.260 (32.0)	0.156 (4.0)
19	1.343 (34.1)	1.062 (27.0)	1.189 (30.2)	0.125 (3.2)
20	1.375 (34.9)	1.062 (27.0)	1.135 (28.8)	0.156 (4.0)
21	1.508 (38.3)	1.140 (29.0)	1.312 (33.3)	0.125 (3.2)
22	1.500 (38.1)	1.156 (29.4)	1.375 (34.9)	0.141 (3.6)
23	1.467 (37.3)	1.156 (29.4)	1.312 (33.3)	0.125 (3.2)
24	1.500 (38.1)	1.156 (29.4)	1.250 (31.8)	0.177 (4.5)
25	1.458 (37.0)	1.187 (30.2)	1.266 (32.2)	0.125 (3.2)
26	1.625 (41.3)	1.250 (31.8)	1.500 (38.1)	0.141 (3.6)
27	1.562 (39.7)	1.250 (31.8)	1.437 (36.5)	0.125 (3.2)
28	1.625 (41.3)	1.250 (31.8)	1.375 (34.9)	0.177 (4.5)
29	1.718 (43.6)	1.281 (32.5)	1.500 (38.1)	0.125 (3.2)
30	1.750 (44.5)	1.375 (34.9)	1.625 (41.3)	0.177 (4.5)
31	1.703 (43.3)	1.375 (34.9)	1.563 (39.7)	0.156 (4.0)
32	1.750 (44.5)	1.375 (34.9)	1.500 (38.1)	0.203 (5.2)
33	1.818 (46.2)	1.392 (35.4)	1.625 (41.3)	0.141 (3.6)
34	1.799 (45.7)	1.436 (36.5)	1.570 (39.9)	0.125 (3.2)
35	1.875 (47.6)	1.500 (38.1)	1.750 (44.5)	0.177 (4.5)
36	2.000 (50.8)	1.562 (39.7)	1.750 (44.5)	0.203 (5.2)
37	2.138 (54.3)	1.568 (39.8)	1.875 (47.6)	0.141 (3.6)
38	2.375 (60.3)	1.719 (43.7)	2.000 (50.8)	0.177 (4.5)
39	2.328 (59.1)	1.734 (44.0)	2.062 (52.4)	0.177 (4.5)
40	2.250 (57.2)	1.750 (44.5)	2.000 (50.8)	0.219 (5.6)
41	2.625 (66.7)	1.906 (48.4)	2.250 (57.2)	0.219 (5.6)
42	2.500 (63.5)	1.938 (49.2)	2.250 (57.2)	0.219 (5.6)
43	2.750 (69.9)	2.188 (55.6)	2.500 (63.5)	0.219 (5.6)
44	3.000 (76.2)	2.375 (60.3)	2.781 (70.6)	0.219 (5.6)
45	3.125 (79.4)	2.406 (61.1)	2.750 (69.9)	0.281 (7.1)
46	3.250 (82.6)	2.625 (66.7)	3.031 (77.0)	0.219 (5.6)
47	3.375 (85.7)	2.656 (67.5)	3.000 (76.2)	0.281 (7.1)
48	3.625 (92.1)	2.906 (73.8)	3.250 (82.6)	0.281 (7.1)
49	3.875 (98.4)	3.156 (80.2)	3.500 (88.9)	0.281 (7.1)

Dimensions are in inches (mm).