

M85049/139 Type Telescoping Bushing

RY85049 Series • M85049 Type Backshells



Photo for example only

RY85049/139 - 3 D

- 1 **BASIC PART NUMBER**
RY85049/139
 M85049/139 type
 Telescoping bushing, neoprene
 (Supersedes MS3420)
- 2 **DASH NO.**
 See dimensions table below
- 3 **MATERIAL (SLEEVE ONLY - OMIT FOR BUSHING)**
A Neoprene
D Silicone
L Fluorosilicone

RY85049/139 Dimensions

Dash No.	A	B	C	D	E	F
3	0.130 (3.3)	0.210 (5.3)	0.379 (9.6)	2.875 (73.0)	0.125 (3.2)	0.210 (5.3)
4	0.220 (5.6)	0.302 (7.7)	0.505 (12.8)	2.750 (69.9)	0.219 (5.6)	0.302 (7.7)
6	0.312 (7.9)	0.427 (10.8)	0.619 (15.7)	2.625 (66.7)	0.312 (7.9)	0.427 (10.8)
8	0.437 (11.1)	0.552 (14.0)	0.744 (18.9)	2.500 (63.5)	0.438 (11.1)	0.531 (13.5)
10	0.562 (14.3)	0.615 (15.6)	0.889 (22.6)	2.375 (60.3)	0.438 (11.1)	0.615 (15.6)
12	0.625 (15.9)	0.740 (18.8)	1.084 (27.5)	2.250 (57.2)	0.541 (13.7)	0.740 (18.8)
16	0.750 (19.1)	0.927 (23.5)	1.314 (33.4)	2.125 (54.0)	0.750 (19.1)	0.927 (23.5)
18	n/a	n/a	n/a	n/a	0.938 (23.8)	1.115 (28.3)
20	0.937 (23.8)	1.240 (31.5)	1.598 (40.6)	2.000 (50.8)	0.938 (23.8)	1.240 (31.5)
24	1.250 (31.8)	1.365 (34.7)	1.847 (46.9)	1.875 (47.6)	1.125 (28.6)	1.365 (34.7)
28	1.375 (34.9)	1.614 (41.0)	2.085 (53.0)	1.750 (44.5)	1.250 (31.8)	1.614 (41.0)
32	1.624 (41.2)	1.864 (47.3)	2.335 (59.3)	1.625 (41.3)	1.625 (41.3)	1.865 (47.4)
40	1.874 (47.6)	2.364 (60.0)	2.835 (72.0)	1.500 (38.1)	1.875 (47.6)	2.365 (60.1)

Dimensions are in inches (mm).

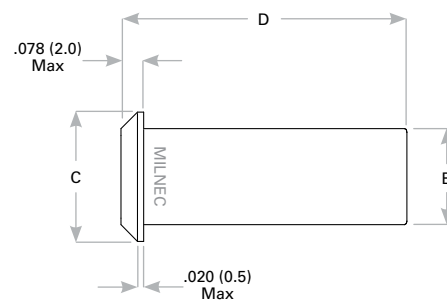
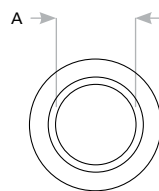

Bushing

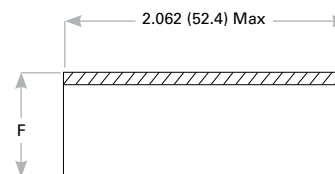
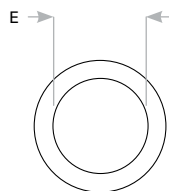

Sleeve

Rev. 1825