

M85049/141 Type 90° Low Profile Heat Shrink Boot

R_Y85049 Series • M85049 Type Backshells



Photo for example only

R_Y85049/141 Compatibility

Compatible Connector Series

Supersedes MS3117

R_Y85049/141 - 10 H C D P

- 1 **BASIC PART NUMBER**
R_Y85049/141
M85049/141 type
90° low profile heat shrink boot
(Supersedes MS3117)
- 2 **DASH NO.**
See dimensions table below
- 3 **MATERIAL**
A Flexible polyolefin
B General purpose polyolefin
G Zero halogen polyolefin
H High performance elastomer
- 4 **ADHESIVE**
C Zero halogen, hot melt
U No adhesive
- 5 **DRAIN HOLES (OMIT FOR NONE)**
D Drain holes
- 6 **INJECTION VENT PORTS (OMIT FOR NONE)**
P Vent ports



Before Heat Activation

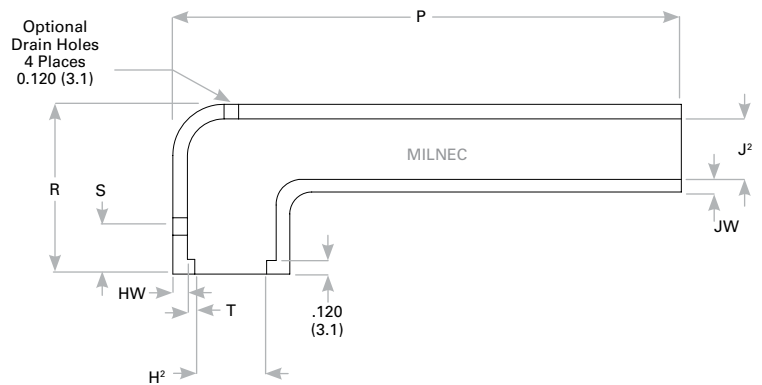

After Heat Activation

(Continued on next page)

Rev. 1825

M85049/141 Type 90° Low Profile Heat Shrink Boot

Ry85049 Series • M85049 Type Backshells

Ry85049/141 Dimensions (Continued from previous page)

Dash No.	H ¹	H ²	J ¹ (Materials A, B, H)	J ¹ (Material G)	J ²	P	R	T	HW	JW Max	S	U
09	0.880 (22.4)	0.450 (11.4)	0.880 (22.4)	0.550 (14.0)	0.250 (6.4)	4.140 (105.2)	0.730 (18.5)	0.040 (1.0)	0.060 (1.5)	0.060 (1.5)	0.470 (11.9)	-
10	1.010 (25.7)	0.590 (15.0)	1.010 (25.7)	0.630 (16.0)	0.300 (7.6)	4.880 (124.0)	0.780 (19.8)	0.040 (1.0)	0.060 (1.5)	0.060 (1.5)	0.470 (11.9)	-
11	1.160 (29.5)	0.740 (18.8)	1.160 (29.5)	0.720 (18.3)	0.330 (8.4)	5.760 (146.3)	0.820 (20.8)	0.040 (1.0)	0.070 (1.8)	0.060 (1.5)	0.470 (11.9)	-
12	1.340 (34.0)	0.900 (22.9)	1.340 (34.0)	0.840 (21.3)	0.390 (9.9)	6.780 (172.2)	0.860 (21.8)	0.040 (1.0)	0.070 (1.8)	0.060 (1.5)	0.470 (11.9)	-
13	1.470 (37.3)	1.160 (29.5)	1.470 (37.3)	0.910 (23.1)	0.430 (10.9)	7.290 (185.2)	0.960 (24.4)	0.070 (1.8)	0.080 (2.0)	0.060 (1.5)	0.470 (11.9)	-
14	1.720 (43.7)	1.340 (34.0)	1.720 (43.7)	1.070 (27.2)	0.480 (12.2)	8.410 (213.6)	1.080 (27.4)	0.070 (1.8)	0.080 (2.0)	0.060 (1.5)	0.470 (11.9)	-
15	1.970 (50.0)	1.620 (41.1)	1.970 (50.0)	1.240 (31.5)	0.570 (14.5)	8.840 (224.5)	1.160 (29.5)	0.070 (1.8)	0.090 (2.3)	0.060 (1.5)	0.470 (11.9)	-
16	2.470 (62.7)	1.850 (47.0)	2.470 (62.7)	1.540 (39.1)	0.710 (18.0)	8.950 (227.3)	1.310 (33.3)	0.080 (2.0)	0.100 (2.5)	0.060 (1.5)	0.630 (16.0)	-
17	2.730 (69.3)	2.350 (59.7)	2.730 (69.3)	1.700 (43.2)	0.790 (20.1)	9.190 (233.4)	1.380 (35.1)	0.080 (2.0)	0.100 (2.5)	0.060 (1.5)	0.630 (16.0)	-
18	3.220 (81.8)	2.640 (67.1)	3.220 (81.8)	2.010 (51.1)	0.910 (23.1)	9.330 (237.0)	1.750 (44.5)	0.080 (2.0)	0.100 (2.5)	0.060 (1.5)	0.630 (16.0)	-

Dimensions are in inches (mm).

