

Jam Nut Receptacle (Box Mount)

HM Series • MIL-DTL-26482 Series 1 Type Connectors



HM07A N 12-10 S N - 02

- 1 **BASIC PART NUMBER**
HM07A Jam nut receptacle (box mount)
- 2 **MATERIAL & FINISH**
F Aluminum, olive drab cadmium
N* Aluminum, electroless nickel
- 3 **SHELL SIZE & INSERT ARRANGEMENT**
See Insert Arrangement Selection table, p. H-9
- 4 **CONTACT STYLE**
P Pin contacts
S Socket contacts
- 5 **INSERT ROTATION**
N Normal or W, X, Y, Z, see p. H-9 for availability
- 6 **OPTIONAL ACCESSORY KIT (OMIT FOR NONE)**
02 Protective cover

* Please consult an authorized distributor for lead time and minimum quantity requirements.

Note: See part builder (p. H-8) for additional kit options.

HM07A Compatibility

Compatible Brands	Equivalent	Mates
MIL-DTL-26482 Series 1	–	MS3116
Amphenol	PT07A	PT06, PT06SE, PT08
Array	PW07A	PW06, PW08
ITT Cannon	KPT07A	KPT06, KPT08
Souriau	85107A	85106, 85108

Receptacle Dimensions

Shell Size	W	J	L	R	M	Q Thread Class 2A	P Max Rear Panel [‡]	H	A
8	.938 (23.8)	.750 (19.1)	.790 (20.1)	.696 (17.7)	.473 (12.0)	.5625-24 NEF	.125 (3.2)	.572 (14.5)	.542 (13.8)
10	1.062 (27.0)	.875 (22.2)	.790 (20.1)	.696 (17.7)	.590 (15.0)	.6875-24 NEF	.125 (3.2)	.697 (17.7)	.669 (17.0)
12	1.250 (31.8)	1.062 (27.0)	.790 (20.1)	.696 (17.7)	.750 (19.1)	.8750-20 UNEF	.125 (3.2)	.884 (22.5)	.830 (21.1)
14	1.375 (34.9)	1.188 (30.2)	.790 (20.1)	.696 (17.7)	.875 (22.2)	1.0000 20 UNEF	.125 (3.2)	1.007 (25.6)	.955 (24.3)
16	1.500 (38.1)	1.312 (33.3)	.790 (20.1)	.696 (17.7)	1.000 (25.4)	1.1250-18 NEF	.125 (3.2)	1.134 (28.8)	1.084 (27.5)
18	1.625 (41.3)	1.438 (36.5)	.790 (20.1)	.696 (17.7)	1.125 (28.6)	1.2500-18 NEF	.125 (3.2)	1.259 (32.0)	1.208 (30.7)
20	1.812 (46.0)	1.562 (39.7)	1.009 (25.7)	.884 (22.5)	1.250 (31.8)	1.3750-18 NEF	.250 (6.4)	1.384 (35.2)	1.333 (33.9)
22	1.938 (49.2)	1.688 (42.9)	1.009 (25.7)	.884 (22.5)	1.375 (34.9)	1.5000-18 NEF	.250 (6.4)	1.507 (38.3)	1.459 (37.1)
24	2.062 (52.4)	1.812 (46.0)	1.042 (26.5)	.917 (23.3)	1.500 (38.1)	1.6250-18 NEF	.250 (6.4)	1.634 (41.5)	1.575 (40.0)

Dimensions are in inches (mm). ‡ Max panel thickness applies only to rear mount applications to ensure proper coupling clearance.

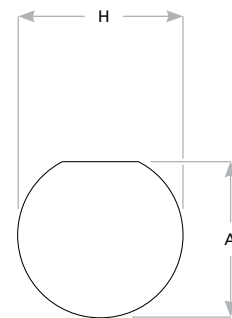
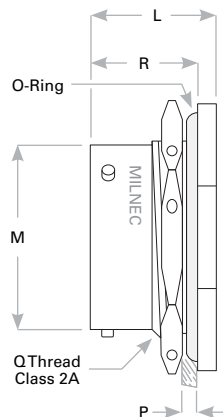
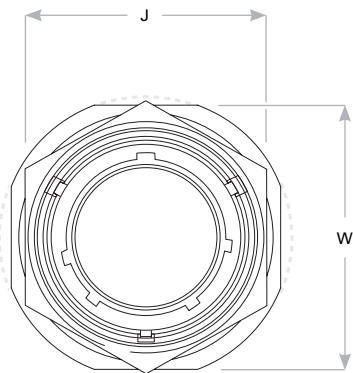

Panel Cutout

Rev. 1913