

MS3475/MS3476 Connector Type Datasheet

BM Series • MIL-DTL-26482 Series 2 Type Connectors



BM06 N 14-18 P N - R2(017) - 01

- 1 **BASIC PART NUMBER**
BM06 Plug
BM05 Plug with RFI grounding fingers
- 2 **MATERIAL & FINISH**
N Aluminum, electroless nickel
W Aluminum, olive drab cadmium
- 3 **SHELL SIZE & INSERT ARRANGEMENT**
 See Insert Arrangement Selection table, p. J-12
- 4 **CONTACT STYLE**
P Pin
S Socket
- 5 **INSERT ROTATION**
N Normal or W, X, Y, Z, see p. J-12 for availability
- 6 **OPTIONAL BACKSHELL KIT (OMIT FOR NONE)**
B2 Straight strain relief (self-locking), p. J-23
R2() Straight EMI/RFI environmental, p. J-34
 (Add dash number for appropriate shell size, see p. J-34)
- 7 **OPTIONAL ACCESSORY KIT (OMIT FOR NONE)**
01 Protective Cover

BM06 Cross Reference & Compatibility

| Compatible Brands | Equivalents | Mates |
|-------------------------------|----------------|--------------------------------|
| MIL-DTL-26482 Series 2 | MS3475, MS3476 | MS3470, MS3471, MS3472, MS3474 |
| Aero / Conesys | AE775, AE776 | AE770, AE771, AE772, AE774 |
| Amphenol / Matrix | MB16, MB18 | MB10, MB11, MB13, MB14 |
| Deutsch | AFD56, AFD57 | AFD50, AFD51, AFD54, AFD58 |
| Souriau | 8526-5, 8526-6 | 8526-0, 8526-7 |

Note: See part builder (p. J-11) for additional kit options.

Plug Dimensions

| Shell Size | D | T | L Max | G | V Thread Class 2A |
|------------|--------------|------------|--------------|--------------|-------------------|
| 8 | .782 (19.9) | .290 (7.4) | 1.405 (35.7) | .305 (7.7) | .500-20 UNF |
| 10 | .926 (23.5) | .290 (7.4) | 1.405 (35.7) | .405 (10.3) | .625-24 UNEF |
| 12 | 1.043 (26.5) | .290 (7.4) | 1.405 (35.7) | .531 (13.5) | .750-20 UNEF |
| 14 | 1.183 (30.0) | .290 (7.4) | 1.405 (35.7) | .665 (16.9) | .875-20 UNEF |
| 16 | 1.305 (33.1) | .290 (7.4) | 1.405 (35.7) | .790 (20.1) | 1.000-20 UNEF |
| 18 | 1.391 (35.3) | .290 (7.4) | 1.405 (35.7) | .869 (22.1) | 1.062-18 UNEF |
| 20 | 1.531 (38.9) | .290 (7.4) | 1.465 (37.2) | .994 (25.2) | 1.188-18 UNEF |
| 22 | 1.656 (42.1) | .290 (7.4) | 1.465 (37.2) | 1.119 (28.4) | 1.313-18 UNEF |
| 24 | 1.777 (45.1) | .290 (7.4) | 1.465 (37.2) | 1.244 (31.6) | 1.438-18 UNEF |

Dimensions are in inches (mm).

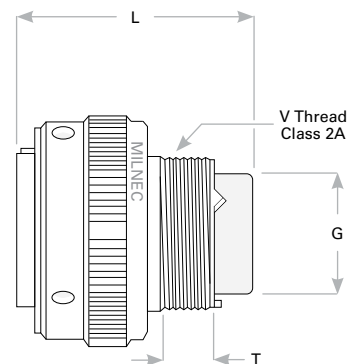
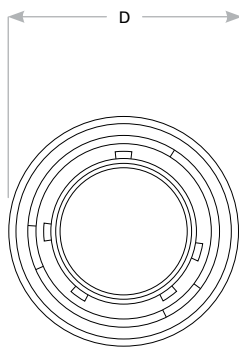

Rev. 1825