

Solder Mount Recept. (Hermetic)

DL Series • MIL-DTL-38999 Series I Style Connectors

DL19 HA 13-98 P N - 02

- 1 **BASIC PART NUMBER**
DL19 Hermetic solder mount receptacle
 Helium leakage 1.0×10^{-7} cc³/sec at
 15 psi (1.1 kg/cm²). Insert rated to 14,000 psi
 (984 kg/cm²) when precision welded or soldered.
- 2 **MATERIAL & FINISH**
HA Stainless steel, passivated
HB Stainless steel, electrodeposited nickel
- 3 **SHELL SIZE & INSERT ARRANGEMENT**
 See Insert Arrangement Selection table, p. N-16
 (Verify hermetic availability on table)
- 4 **CONTACT STYLE**
P Pin, gold plated, solder cup termination
H* Socket, gold plated, solder cup termination
- 5 **ALTERNATE KEYING**
N NORMAL or A, B, C, D
- 6 **OPTIONAL ACCESSORY KIT (OMIT FOR NONE)**
02 Protective cover

* Please consult an authorized distributor for lead time and minimum quantity requirements.



DL19 Compatibility

Compatible Brands	Mates
MIL-DTL-38999 Series I	MS27467
Aero / Conesys	AE167
Amphenol	LJT06, LJTS06
Deutsch	DJT6
ITT Cannon	KJL6
Souriau	8LT5

Receptacle Dimensions

Shell Size	K	D	L	F	T	E	M	U	H Front Mount
9	.662 (16.8)	.750 (19.1)	.789 (20.0)	.031 (.8)	.125 (3.2)	.304 (7.7)	.572 (14.5)	.672 (17.1)	.702 (17.8)
11	.810 (20.6)	.844 (21.4)	.789 (20.0)	.031 (.8)	.125 (3.2)	.304 (7.7)	.700 (17.8)	.781 (19.8)	.811 (20.6)
13	.960 (24.4)	.969 (24.6)	.789 (20.0)	.031 (.8)	.125 (3.2)	.304 (7.7)	.850 (21.6)	.906 (23.0)	.936 (23.8)
15	1.085 (27.6)	1.094 (27.8)	.789 (20.0)	.031 (.8)	.125 (3.2)	.304 (7.7)	.975 (24.8)	1.031 (26.2)	1.061 (27.0)
17	1.210 (30.7)	1.218 (30.9)	.789 (20.0)	.031 (.8)	.125 (3.2)	.304 (7.7)	1.100 (27.9)	1.156 (29.4)	1.186 (30.1)
19	1.317 (33.5)	1.312 (33.3)	.789 (20.0)	.031 (.8)	.125 (3.2)	.304 (7.7)	1.207 (30.7)	1.250 (31.8)	1.280 (32.5)
21	1.442 (36.6)	1.438 (36.5)	.789 (20.0)	.031 (.8)	.125 (3.2)	.304 (7.7)	1.332 (33.8)	1.375 (34.9)	1.405 (35.7)
23	1.567 (39.8)	1.563 (39.7)	.821 (20.9)	.031 (.8)	.156 (4.0)	.304 (7.7)	1.457 (37.0)	1.500 (38.1)	1.530 (38.9)
25	1.692 (43.0)	1.688 (42.9)	.821 (20.9)	.031 (.8)	.156 (4.0)	.304 (7.7)	1.582 (40.2)	1.625 (41.3)	1.655 (42.0)

Dimensions are in inches (mm).

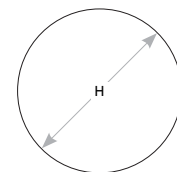
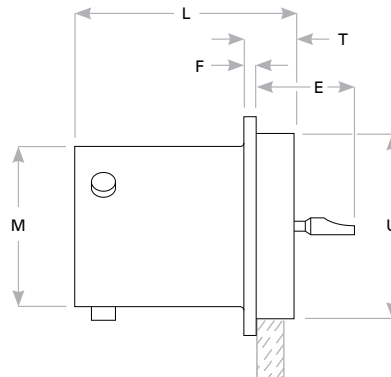
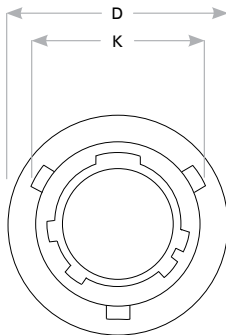

Panel Cutout

Rev. 2150