

Plug (Self-Locking)

TX Series • MIL-DTL-38999 Series III Style Connectors



TX06 Cross-Reference & Compatibility

Compatible Brands	Equivalents	Mates
MIL-DTL-38999 Series III	D38999/26	D38999/20, D38999/24
Aero / Conesys	AE326	AE320, AE324
Amphenol	TV06, TVS06	TVP00, TVPS00, TVP07, TVPS07
Deutsch	DTS26	DTS20, DTS24
ITT Cannon	KJA6	KJA0, KJA7
Souriau	8D5, 8DS06G	8D0, 8D1, 8D7, 8DS00, 8DS07

Plug Dimensions

Shell Size	Military Shell Size	W	C Thread Class 2B	L	V Thread Class 2A
9	A	.858 (21.8)	.6250- 0.1P-0.3L-TS-2B	1.234 (31.3)	M12X1-6g
11	B	.984 (25.0)	.7500- 0.1P-0.3L-TS-2B	1.234 (31.3)	M15X1-6g
13	C	1.157 (29.4)	.8750- 0.1P-0.3L-TS-2B	1.234 (31.3)	M18X1-6g
15	D	1.280 (32.5)	1.0000- 0.1P-0.3L-TS-2B	1.234 (31.3)	M22X1-6g
17	E	1.406 (35.7)	1.1875- 0.1P-0.3L-TS-2B	1.234 (31.3)	M25X1-6g
19	F	1.516 (38.5)	1.2500- 0.1P-0.3L-TS-2B	1.234 (31.3)	M28X1-6g
21	G	1.642 (41.7)	1.3750- 0.1P-0.3L-TS-2B	1.234 (31.3)	M31X1-6g
23	H	1.768 (44.9)	1.5000- 0.1P-0.3L-TS-2B	1.234 (31.3)	M34X1-6g
25	J	1.890 (48.0)	1.6250- 0.1P-0.3L-TS-2B	1.234 (31.3)	M37X1-6g

Dimensions are in inches (mm).

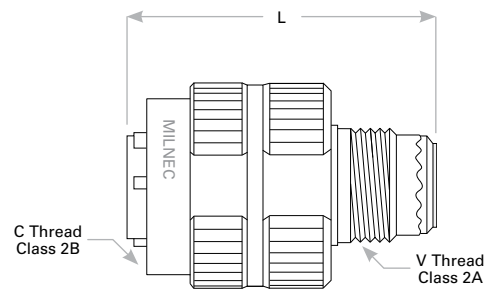
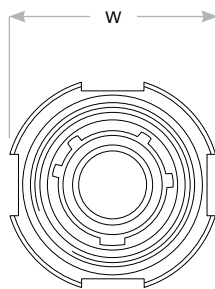

TX06 K 13-35 P N - R2(015) - 01

- 1 **BASIC PART NUMBER**
TX06 Plug (self-locking)
- 2 **MATERIAL & FINISH**
K Stainless steel, passivated (firewall)
KS Stainless steel, electrodeposited nickel (firewall)
L Stainless steel, electrodeposited nickel
- 3 **SHELL SIZE & INSERT ARRANGEMENT**
See Insert Arrangement Selection table, p. B-19
- 4 **CONTACT STYLE**
P Pin
S Socket
- 5 **ALTERNATE KEYING**
N NORMAL or A, B, C, D, E
- 6 **OPTIONAL BACKSHELL KIT (OMIT FOR NONE)**
B2 Straight strain relief (self-locking), p. B-33
R2() Straight EMI/RFI environmental, p. B-35
(Add dash number for appropriate shell size, see p. B-35)
K2 Boot adapter, p. B-47, & straight shrink boot, p. B-45
- 7 **OPTIONAL ACCESSORY KIT (OMIT FOR NONE)**
01 Protective cover

Note: See part builder in TX Series catalog (p. B-17) for more kit options.

Rev. 1301.1