

Wall Receptacle With PCB Standoff

TX Series • MIL-DTL-38999 Series III Style Connectors

TX30 N 13-35 X 1 1 N - 03

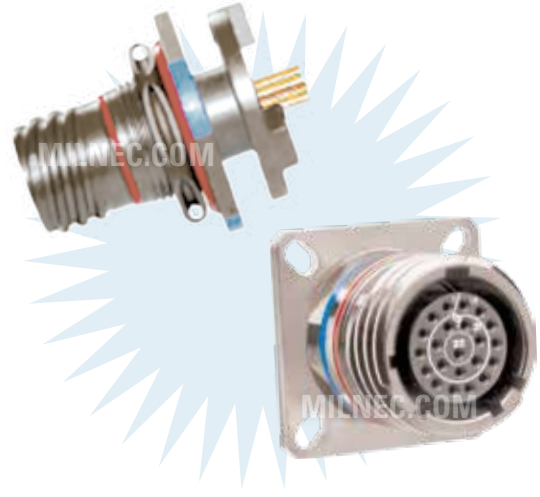

- 1 **BASIC PART NUMBER**
TX30 Wall mount receptacle with PCB standoff
- 2 **MATERIAL & FINISH**
N Aluminum, electroless nickel
W Aluminum, olive drab cadmium
K Stainless steel, passivated (firewall)
- 3 **SHELL SIZE & INSERT ARRANGEMENT**
See Insert Arrangement Selection table, p. B-19
- 4 **CONTACT STYLE**
X Pin
Y Socket
- 5 **PC TAIL LENGTH (CUSTOM LENGTHS AVAILABLE)**
1 0.098 (2.5) 4 0.236 (6.0)
2 0.177 (4.5) 5 0.472 (12.0)
3 0.217 (5.5) 6 0.707 (18.0)
- 6 **THREAD TYPE**
1 4-40 UNC threads
2 M3 metric threads
- 7 **ALTERNATE KEYING**
N NORMAL or A, B, C, D, E
- 8 **OPTIONAL ACCESSORY KIT (OMIT FOR NONE)**
02 Protective cover + mounting gasket
03 02 kit + mounting bracket + sealing screws

TX30 Compatibility

Compatible Brands	Mates
MIL-DTL-38999 Series III	D38999/26
Aero / Conesys	AE326
Amphenol	TV06, TVS06, CTV06, CTVS06
Deutsch	DTS26
ITT Cannon	KJA6
Souriau	8D5, 8DS06G

Receptacle Dimensions

Shell Size	Military Shell Size	W Rear	L	D	S	Dia	C Thread Class 2A	H	X
9	A	.938 (23.8)	1.310 (33.3)	.315 (8.0)	.630 (16.0)	.520 (13.2)	.6250-0.1P-0.3L-TS	.656 (16.7)	.128 (3.3)
11	B	1.031 (26.2)	1.310 (33.3)	.394 (10.0)	.719 (18.3)	.661 (16.8)	.7500-0.1P-0.3L-TS	.796 (20.2)	.128 (3.3)
13	C	1.125 (28.6)	1.310 (33.3)	.512 (13.0)	.812 (20.6)	.795 (20.2)	.8750-0.1P-0.3L-TS	.922 (23.4)	.128 (3.3)
15	D	1.219 (31.0)	1.310 (33.3)	.591 (15.0)	.906 (23.0)	.937 (23.8)	1.0000-0.1P-0.3L-TS	1.047 (26.6)	.128 (3.3)
17	E	1.312 (33.3)	1.310 (33.3)	.669 (17.0)	1.028 (26.1)	1.024 (26.0)	1.1875-0.1P-0.3L-TS	1.219 (31.0)	.128 (3.3)
19	F	1.438 (36.5)	1.310 (33.3)	.748 (19.0)	1.072 (27.2)	1.161 (29.5)	1.2500-0.1P-0.3L-TS	1.297 (32.9)	.128 (3.3)
21	G	1.562 (39.7)	1.310 (33.3)	.827 (21.0)	1.156 (29.4)	1.268 (32.2)	1.3750-0.1P-0.3L-TS	1.422 (36.1)	.128 (3.3)
23	H	1.688 (42.9)	1.310 (33.3)	.945 (24.0)	1.250 (31.8)	1.398 (35.5)	1.5000-0.1P-0.3L-TS	1.547 (39.3)	.147 (3.7)
25	J	1.812 (46.0)	1.310 (33.3)	1.024 (26.0)	1.375 (35.0)	1.520 (38.6)	1.6250-0.1P-0.3L-TS	1.672 (42.5)	.147 (3.7)

Dimensions are in inches (mm).

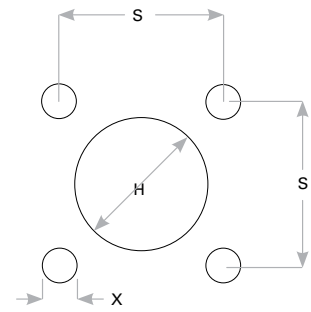
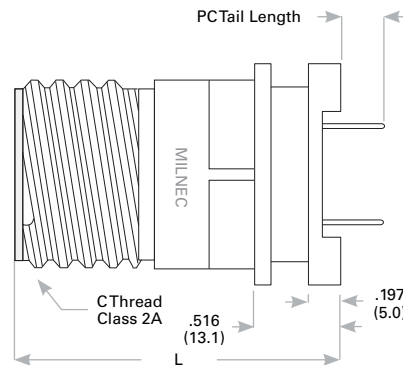
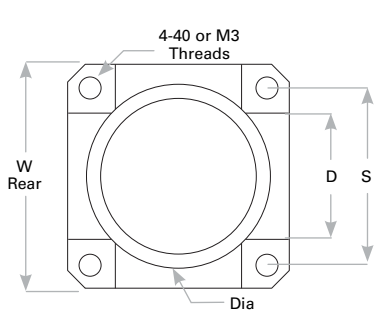

Panel Cutout

Rev. 1338.1