

QSAE - 20 C

- 1 **BASIC PART NUMBER**
QSAE Adapter (shell extender)
- 2 **SHELL SIZE**
See Adapter Dimensions table below
- 3 **MATERIAL AND FINISH**
 - C Aluminum, conductive (olive drab cadmium)
 - N Aluminum, non-conductive (anodized)

Note: QSAE adapter is required to couple QSB2 backshell.



QSAE Compatibility

| Compatible Brands | Connectors |
|--------------------|--|
| MIL-DTL-22992 QWLD | MS17343, MS17344, MS17345, MS17347 |
| Amphenol | 10-1940, 10-1941, 10-1943, 10-1946, 88-1940, 88-1941, 88-1943, 88-1946 |
| ITT Cannon | CWLD00, CWLD01, CWLD06, CWLD07 |

Adapter Dimensions

| Shell Size | W | C Dia. | C Thread Class 2B-LH | L | D | V Thread Class 2A-LH |
|------------|--------------|--------------|----------------------|--------------|--------------|----------------------|
| 12 | .688 (17.5) | .386 (9.8) | .750-20UNEF | 1.609 (40.9) | .875 (22.2) | .625-24UNEF |
| 14 | .812 (20.6) | .500 (12.7) | .875-20UNEF | 1.609 (40.9) | 1.000 (25.4) | .750-20UNEF |
| 16 | .938 (23.8) | .625 (15.9) | 1.000-20UNEF | 1.609 (40.9) | 1.188 (30.2) | .875-20UNEF |
| 18 | 1.062 (27.0) | .752 (19.1) | 1.125-18UNEF | 1.609 (40.9) | 1.312 (33.3) | 1.000-20UNEF |
| 20 | 1.250 (31.8) | .891 (22.6) | 1.250-18UNEF | 1.609 (40.9) | 1.438 (36.5) | 1.1875-18UNEF |
| 22 | 1.250 (31.8) | .891 (22.6) | 1.375-18UNEF | 1.609 (40.9) | 1.562 (39.7) | 1.1875-18UNEF |
| 24 | 1.500 (38.1) | 1.111 (28.2) | 1.625-18UNEF | 1.609 (40.9) | 1.812 (46.0) | 1.4375-18UNEF |
| 28 | 1.500 (38.1) | 1.111 (28.2) | 1.875-16UN | 1.781 (45.2) | 2.062 (52.4) | 1.4375-18UNEF |
| 32 | 1.875 (47.6) | 1.422 (36.1) | 2.0625-16UNS | 1.781 (45.2) | 2.250 (57.2) | 1.750-18UNS |
| 36 | 2.125 (54.0) | 1.672 (42.5) | 2.3125-16UNS | 1.781 (45.2) | 2.500 (63.5) | 2.000-18UNS |
| 40 | 2.375 (60.3) | 1.914 (48.6) | 2.625-16UN | 2.032 (51.6) | 2.812 (71.4) | 2.250-16UN |

Dimensions are in inches (mm).

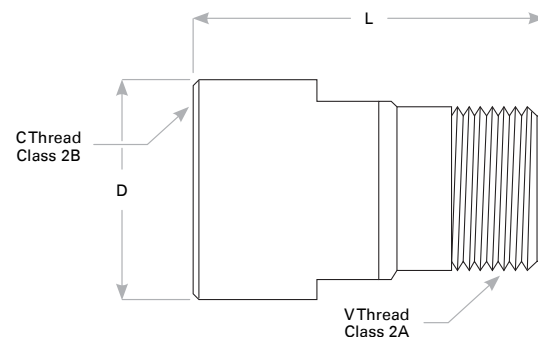
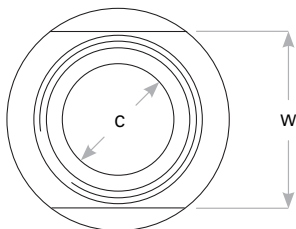

Rev. 2134

SD