

# MS27511 Type Protective Receptacle Cover

Ry85049 Series • M85049 Type Backshells

## Ry27511 F 14 C L

- 1 **BASIC PART NUMBER**  
Ry27511  
MS27511 type  
Protective receptacle cover  
(supersedes MS27353)
- 2 **MATERIAL & FINISH**
  - A Aluminum, gold iridite over cadmium over nickel
  - B Aluminum, olive drab cadmium
  - C Aluminum, anodize
  - F Aluminum, electroless nickel
- 3 **SHELL SIZE**  
See Dimensions table below
- 4 **ATTACHMENT OPTION**
  - A No attachment
  - C Chain
  - N Chain with ring
  - R Rope
- 5 **LENGTH (OMIT FOR STANDARD)**  
L 5.000 (127.0)



Photo for example only

### Ry27511 Compatibility

Compatible Connector Series
MIL-DTL-38999, Series II

### Protective Cover Dimensions

Shell Size	E	L	D	H
8	.167 (4.2)	.781 (19.8)	.630 (16.0)	.890 (22.6)
10	.167 (4.2)	.781 (19.8)	.761 (19.3)	1.010 (25.7)
12	.167 (4.2)	.781 (19.8)	.936 (23.8)	1.140 (29.0)
14	.167 (4.2)	.781 (19.8)	1.074 (27.3)	1.260 (32.2)
16	.167 (4.2)	.781 (19.8)	1.172 (29.8)	1.390 (35.3)
18	.167 (4.2)	.781 (19.8)	1.304 (33.1)	1.510 (38.4)
20	.167 (4.2)	.781 (19.8)	1.435 (36.4)	1.640 (41.7)
22	.167 (4.2)	.781 (19.8)	1.560 (39.6)	1.760 (44.7)
24	.167 (4.2)	.781 (19.8)	1.688 (42.9)	1.890 (48.0)

Dimensions are in inches (mm).

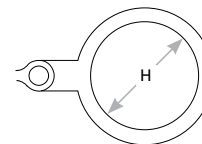
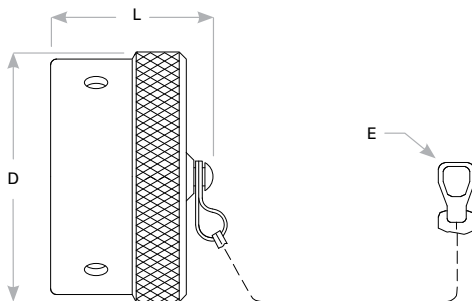

Jam Nut Ring Attachment

Rev. 1825